

**PARTING LOCKS**

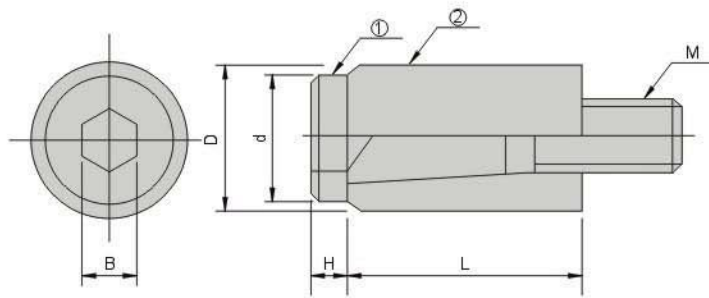

**GPLA**



**M** ①SCM435

**Features:**

1. Use sloping screw to adjust mold plate and parting locks, then turn 90 degrees. Parting locks can be closed up to 50,000 times.
2. Easy to assemble and disassemble, and cost efficient.
3. Can also be installed into small, medium size, and 2-sectional injecting metal pipes, or can be installed on sliding bases.
4. Mold weight < 100kg, using 4 pcs of 12 $\varnothing$   
 Mold weight < 500kg, using 4 pcs of 16 $\varnothing$   
 Mold weight < 1,000kg, using 4 pcs of 20 $\varnothing$   
 Mold weight > 1,000kg, using at least 6 pcs.
5. Insert Parting Locks into die mold about 3cm, then using H7 reamer to process mold hole within +0.1mm range.
6. Process mold surface to the shape of letter R. If processing to the chamfering of letter C, it will shorten its life cycle.
7. Do not add any oil on parting locks, doing so will reduce the friction.

Colour: white. yellow. orange

Type	D	d	H	L	M	B
GPLA	10	8.5	3	18	M5	4
	12	11	3.5	20	M6	5
	13	11	3.5	20	M6	5
	16	14	4	25	M8	6
	20	16	5	30	M10	8



Order: **GPLA** - **D** - **QTY**